



## The District at Howell Mill

When Selig Enterprises was developing a design team to change the landscape of Berkley Park in the City of Atlanta for a new mixed-use development, they chose Urban Engineers, Inc. The site was known to be controversial, due to a previous concept of a Home Depot facility, which was denied by the local neighborhood association citing site-use concerns. The mixed-use concept that Selig proposed helped to ease concerns that the Berkley Park Neighborhood Association initially held; also, subse-



quently working with the Association on concerns of pedestrian access, reduced vehicular flow in the neighborhood, and the enhanced protection of the existing vegetation on this urban site. Urban Engineers, Inc. performed the initial land survey of the Castlegate facility and developed a demolition plan to remove the abandoned and condemned structure, allowing the redevelopment to begin. Urban Engineers, Inc. overcame many obstacles in obtaining approval from the City of Atlanta due to the dense urban nature of this project

and changing stormwater regulations. The site utilizes a concrete vault for stormwater detention-

designed as the central pond for both the residential and commercial developments-that is 330' in length, 40' wide and 11' in height; it's located under the Wal-Mart parking lot. The site permit was issued ahead of schedule, allowing the contractor to begin with the massive task of the site work. Urban Engineers, Inc. performed the critical site layout work for the contractor, as well as as-built surveys, as phases were completed. This landmark project for metro-Atlanta was completed on schedule!

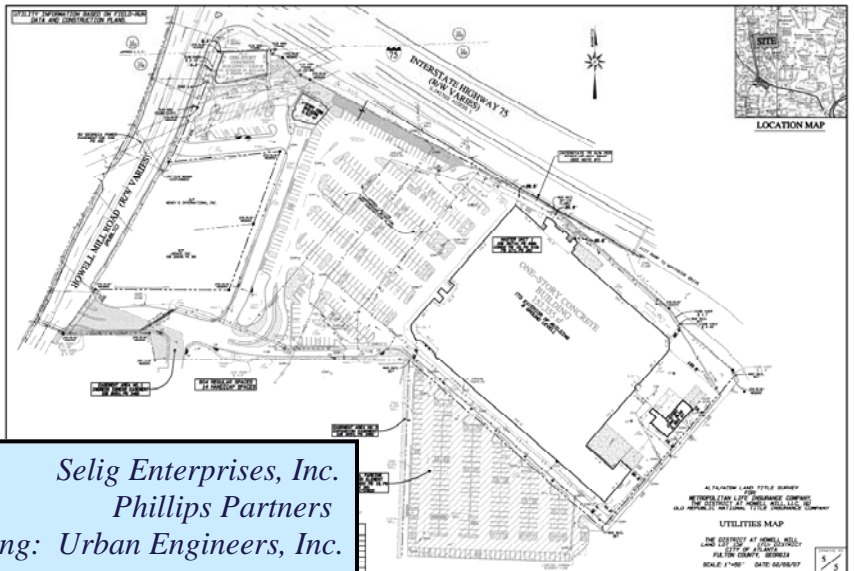

*Developer :* Selig Enterprises, Inc.  
*Architect:* Phillips Partners  
*Surveyor & Civil Eng:* Urban Engineers, Inc.

URBAN ENGINEERS, INC.